

kadaster



Privacy and open INSPIRE data

Case the Netherlands

Haico van der Vegt
Strategic Advisor
Kadaster

kadaster

INSPIRE in the Netherlands

- All INSPIRE data is open data....:
 - Data is public
 - No copyright
 - Financed by government
 - Using open standards
 - (..but not always free of charge..)
- ...unless:
 - There is personal data involved
 - Information is confidential (military, citizen protection, etc.)
 - Data is otherwise classified (e.g. safety)



INSPIRE themes

Annex I

Coordinate Reference Systems
Geographical Grid Systems
Geographical Names
Administrative Units
Addresses
Cadastral Parcels
Transport Networks
Hydrography
Protected Sites

Annex II

Elevation
Land Cover
OrthoImagery
Geology

Annex III

Statistical units
Buildings
Soil
Land use
Human health and safety
Utility and governmental services
Environmental monitoring facilities
Production and industrial facilities
Agricultural and aquaculture facilities
Population distribution - demography
Area management/
restriction/regulation

Natural risk zones
Atmospheric conditions
Meteorological geographical features
Oceanographic geographical features
Sea regions
Bio-geographical regions
Habitats and biotopes
Species distribution
Energy resources
Mineral resources

INSPIRE themes

- Theme Cadastral Parcels:
 - Cadastral Map source for CP
 - Ministry wants to make Cadastral Map open data
 - Personal data?
 - Scrutinized by Data Protection Authority of NL
 - No definitive conclusion from DPA
 - Decision to make Cadastral Map open data (also CP)
- Theme Utilities and Governmental Services, sub-theme Utility Networks:
 - Issue is not privacy, but safety
 - High risk cables & pipelines
 - Authentication and authorization needed

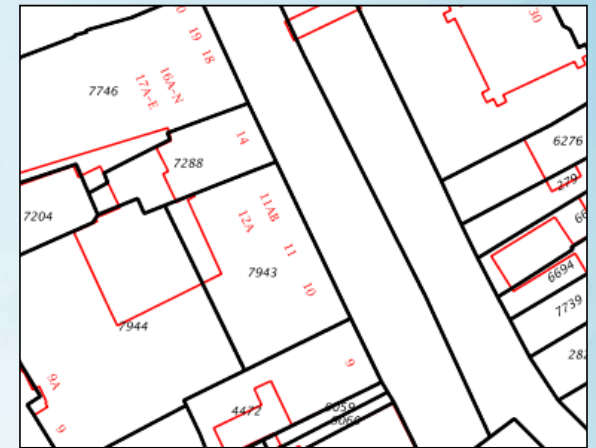

Kadaster and open reference data

System of key registries:

- Cadastral Map / parcels: CC-BY
 - Not administrative / land registry data, is personal information
- Small scale topography << 1:10.000: CC-BY
- Addresses & Buildings: CC-0
- Large scale topography >> 1:2.000: CC-0
- Property values: not public (yet)

Other databases:

- Planned Land Use: CC-0
- Public Restrictions: CC-0
- Cables & Pipelines: not public

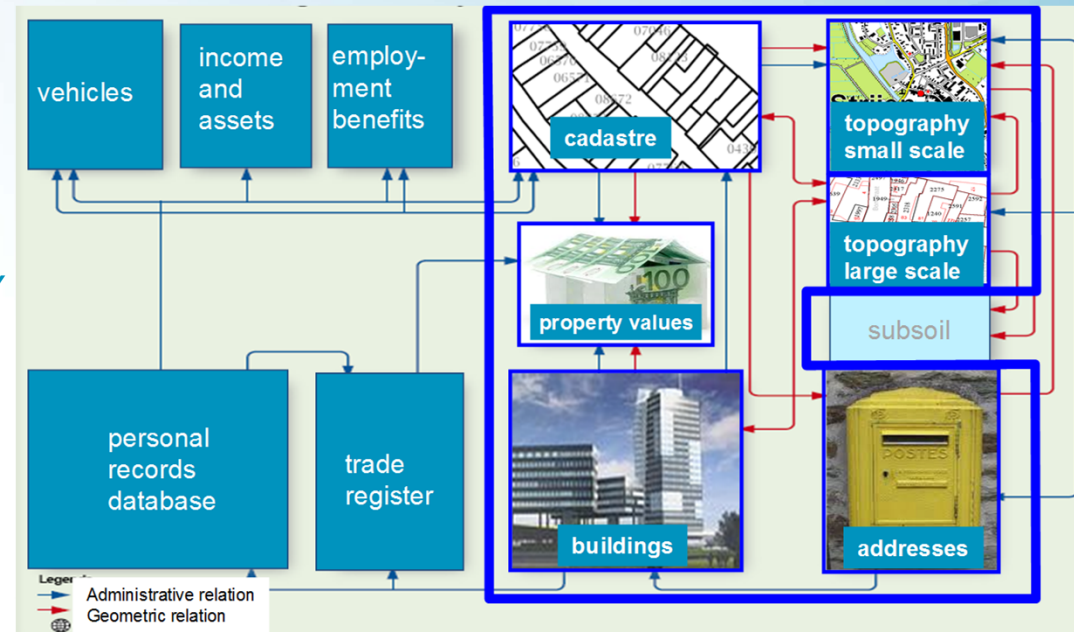

Future...

- Growth of availability of all kinds of data
 - Individual datasets: no personal data
 - Better technology, more expertise
 - More possibilities to combine data and 'reveal' the person behind the data
 - Privacy issues will grow
-
- Reference information like addresses, buildings, parcels, topography....all personal data in the future?
 - Discussion needed



**PRIVATE &
CONFIDENTIAL**